

CVUSD | *Facilities Master Plan*

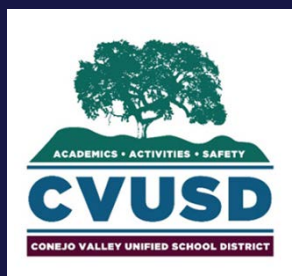

CVUSD - WESTLAKE CLUSTER



Conejo Elementary School | *Survey*

280 North Conejo School Road | Thousand Oaks, CA 91362

Conejo Valley Unified School District

March 31, 2017

NAC Architecture

837 North Spring Street 3rd Floor |
Los Angeles, CA 90012

Contact: 323.475.8075

E-mail: lochoa@nacarchitecture.com

Website: www.nacarchitecture.com

Existing Site Summary

Neighborhood:

Conejo Elementary is located in Thousand Oaks, bound by North Conejo School Road to the northwest, Bayer Park to the west, and a church and residential properties to the east and south. The campus is in a mixed commercial/residential area, and is adjacent to Conejo Ridge Open Space. The closest major intersection is Thousand Oaks Boulevard and Erbes Road.

Instruction:

Conejo Elementary School currently serves a total of 362 students from Kindergarten through 5th grade. 110 of those students are in the Open Classroom Leadership Magnet (OCLM), which is an application based program. The campus also houses one building for a County Special Education program. In addition to their general education instruction, the campus places a strong emphasis on leadership. These values are integrated into everyday curriculum and are woven into the year through mentoring efforts and special projects. After school enrichment programs are available to students, as well as before and after school child care.

Summary of Facilities:

The campus was built between 1940 and 1973, with several portable buildings added between 1990 and 2003. The core campus buildings are constructed with steeply sloped gabled roofs that mimic the rooflines found in the surrounding neighborhood. Exposed wood beams support the exterior covered walkways, adding to the warm character of the campus. Large windows and high ceilings allow natural daylight to flood into classroom spaces in permanent buildings. While the structures appear to be in good working condition, the site is challenged by aging infrastructure.

The campus is organized into two halves, with the majority of play space to the west, buildings to the east, and several perimeter parking lots. The community and school share use of the adjacent play field (Beyer Park). The site is populated with many mature trees and is well landscaped with several lawn courtyards. However, there are several grade changes throughout the campus, which is a challenge for the school and particularly for the students in the special education program. As a result of the sloping topography, drainage concerns have been noted.

Building Systems:

Being the first elementary school in Conejo Valley, and its oldest structure over 70 years old, the site infrastructure is aging. While maintenance has been done throughout the years, the plumbing system is prone to backing up and is need of repairs. Galvanized plumbing is used in classrooms. Split system HVAC units that service classrooms are nearing the end of their useful life. Power upgrades are required for the campus, as well as better electrical distribution throughout all classroom spaces. Roofing at the Multi-Purpose building is due for replacement.

Technology:

New fiber and copper connections have been installed on the campus, and the site enjoys full Wi-Fi coverage. To support the school's growing need for laptops, additional charging stations would be beneficial. Digital signage throughout the school was noted to be a desired amenity.

Energy:

There are currently no renewable energy systems installed on campus. Gas and electricity use across the past 3 years are relatively consistent indicating similar demands and the unlikelihood of gas leaks and/or errant electricity use. Water use data for the past year indicates an increase in water use in from 2015. As the current HVAC equipment is nearing the end of their useful life, there is an opportunity to install more energy efficient models/systems to further reduce the demand for energy.

Building Systems:

Being the first elementary school in Conejo Valley, and its oldest structure over 70 years old, the site infrastructure is aging. While maintenance has been done throughout the years, the plumbing system is prone to backing up and is need of repairs. Galvanized plumbing is used in classrooms. Split system HVAC units that service classrooms are nearing the end of their useful life. Power upgrades are required for the campus, as well as better electrical distribution throughout all classroom spaces. Roofing at the Multi-Purpose building is due for replacement.

Site Opportunities:

There are several opportunities for improving the campus environment. The sloping nature of the site results in drainage and accessibility concerns across the campus. Implementing solutions to water intrusion, noted to occur at Classroom Building 12, as well as a holistic review of creating accessible paths of travel throughout the site would be of great benefit. Accessible and even distribution of restrooms may be remedied along with infrastructural upgrades to the school's aging plumbing and sewer lines. Though the campus is enclosed with perimeter fencing, it was noted that safety was a concern. There is an opportunity here to explore the use of landscaping, fencing and site lighting to enhance the school's security. Simultaneously, the campus' face to the neighborhood may also be modernized.

Table of Contents

0.0	Cover Sheet
1.0	Table of Contents / Executive Summary
2.0	Complex Context Map
INSTRUCTIONAL INFORMATION	
3.0	Project Location Plan & Data
4.0	Instructional & Campus Summary
5.1	Existing Campus Plan
5.2	Existing Campus Building Data
6.0	Existing Campus Building Use - First Floor
7.0	Existing Campus Image Key Map
7.1	Existing Campus Images
7.2	Existing Campus Images
7.3	Existing Campus Images
8.0	Specialized Program
FACILITY INFORMATION	
9.0	Facility Certification Requirements
	Site Challenges & Proposed Site Modernization Summary
10.0	
10.1	Drop-off Points and Circulation
10.2	Facility Accessibility
11.0	Energy Use
12.0	Core Facilities Data
TECHNOLOGY	
13.0	Campus Technology
13.1	Campus Technology Continued
PROJECT REQUESTS	
14.0	Observations Summary



CVUSD Westlake Cluster



Legend

	Elementary School		Special Education School
	Middle School		Magnet School
	High School		Parks

CVUSD Westlake Cluster Sites

LOCATION CODE	SITE NAME	SCHOOL MANAGEMENT SERVICES SITE TYPE	GRADE LEVEL CONFIG
33-260	WESTLAKE	Elem. School	K-5
34-270	WESTLAKE	High School	9-12
20-210	TRIUNFO / CARDEN CONEJO	Charter School	Pre K- 5
8-050	CONEJO	Magnet/Elem. School	K- 5
35-280	WESTLAKE HILLS	Elem. School	K- 5
6-040	COLINA	Middle School	6-8
16-105	LANG RANCH	Elem. School	K- 5
17-110	LOS CERRITOS	Middle School	6-8
21-150	MEADOWS ARTS AND TECHNOLOGY	Charter School	K-5
9	Total Sites		

Community Resources

DESCRIPTION	LOCATION	CITY
Conejo Ridge Open Space	Various trailheads	Thousand Oaks
Triunfo Community Park	980 Aranmoor Ave	Thousand Oaks
Westlake Village Library	31220 Oak Dr	Westlake Village
Berniece Bennett Park	31800 Village Center Rd	Westlake Village
Evenstar Triunfo Greenbelt	Various trailheads	Westlake Village
Conejo Valley Makerspace	31352 Via Colinas #104	Westlake Village
The Discovery Center for Science and Technology	600 Hampshire Rd #140	Westlake Village
Westlake Village Park/YMCA	31105 Thousand Oaks Blvd	Westlake Village
Thousand Oaks Civic Arts Plaza	2100 Thousand Oaks Blvd	Thousand Oaks
Conejo Creek South Park	1300 E Janss Rd	Thousand Oaks





Conejo Elementary School | Survey
280 North Conejo School Road | Thousand Oaks, CA 91362
Conejo Valley Unified School District
March 31, 2017

Project Location Map



Conejo Elementary

FACILITIES - CLASSROOM INVENTORY									
K-12 School Facility	Grade/Type	Number of Teaching Stations					Projections		
		Total # of Teaching Stations	Permanent	Modulars			Teaching Stations		
				Quality Modulars	Owned Portables	Leased Portables	Capacity	Rms Utilized	Ratio
		As used for the 15/16 School Year					Based on 16/17		
K - All Day	Jr K	0	0				0	20.00	
	K	6	4	2			120	2	22.00 47
*1-3 includes T1, PC, Spch	1-3	9	6	3			180	7	22.00 145
*4-5 includes Title 1 Spch	4-5	12	4	8			360	3	30.00 99
*6 Combined w/4-5	6	0					0		
*7 Mod classrooms City SDC not in inventory	SDC	0	0					1	0
*NFL NOT included	LC	1	1					1	0
	LAB	1	1					1	0
Sub-Total K-5		29	16	13	0	0	660	15	291

ENROLLMENT HISTORY - 2nd Month Report																				
Grade	2017	2016	2015	2014	2013	2012	2011	2010	2009	2008	2007	2006	2005	2004	2003	2002	2001	2000	1999	1998
Jr K																				
K		49	65	62	66	77	75	94	90	87	94	81	95	93	86	76	92	89	87	94
1		66	65	72	74	77	84	84	74	96	80	89	103	70	74	95	93	87	96	85
2		57	72	74	70	80	69	61	91	76	88	92	77	71	88	93	81	91	83	103
3		63	74	60	78	74	53	74	67	84	87	78	81	87	88	73	99	75	95	68
4		66	59	73	68	49	76	56	72	90	74	74	82	68	80	90	85	73	65	64
5		61	73	67	46	77	65	56	83	73	78	76	74	83	88	85	78	64	62	60
6								2	18	20	17	17	64	65	66	67	40	58	38	46
Total Elem	0	362	408	408	402	434	422	427	495	526	518	507	576	537	570	579	568	537	526	520
Special Ed	0	0	0	0	0	0	0	0	0	3	6	11	14	11	7	10	8	11	16	14
TOTAL	0	362	408	408	402	434	422	427	495	529	524	518	590	548	577	589	576	548	542	534

PRINCIPAL PROJECTIONS											
Grade	Forecast		4/23/2015	5/26/2015	8/18/2015	Primary & Upper Totals	Teacher Calculation			15-16 Budget Calc	14-15 Staffing
	Students	Teachers					Teacher by Ratio	Students Per class	Traditional		
Special Ed											
TK											
K	52	2.42	40	45	46		2.14		22		
1	65	3.02	44	44	45	188	2.09	8.74	22	9	10
2	70	3.26	51	51	51		2.37		22		
3	69	3.21	47	48	46		2.14		22		
4	54	1.80	42	43	44	99	1.47	3.30	30	3	3
5	73	2.43	54	54	55		1.83		30		
TK - 5	383	11.91	278	285	287	287					
		4.23									
TOTAL	383	16.14	278	285	287	287	12.04		12	13	

Enrollment Data:

•For Secondary Schools

Classrooms 800 Square Feet and greater will be considered an "Available Classroom". On the color coded survey plan they can occur as BASIC CLASSROOM (Orange); SPECIALITY CLASSROOM (Light Blue); SCIENCE (Yellow).

If the rooms are being used for instruction and they are 799 Square Feet and under, they will be considered a "Small Room", with a different Color Code. Provide a description in the keynote as to its current use.

•For Elementary Schools

Classrooms 720 Square Feet and greater will be considered an "Available Classroom". On the color coded survey plan they can occur as BASIC CLASSROOM (Orange); SPECIALITY CLASSROOM (Light Blue); SCIENCE (Yellow).

If the rooms are being used for instruction and they are 719 Square Feet and under, they will be considered a "Small Room", with a Different Color Code. Provide a description in the keynote as to its current use.

For Span and other types of Schools

Identify what age group the space is used for the majority of the day – use rules above for Secondary Schools and Elementary Schools. Provide a description in the keynote as to its current use.

CVUSD CONEJO ELEMENTARY Location Code: 8-050 Campus Summary										
Site Information	Totals			Total Planned Site Capacity:			Totals			
Current Useable Area:	11.0 Acres			Current Enrollment:			362			
Current Playground Area:	2.95 Acres			Planning 2-Semester Capacity:			660			
				Enrollment to use for Planning			291			
Playground Area Required	1.61 Acres									
	Current Classrooms			Potential Classrooms + Current Classrooms			Classrooms Identified by the School			
Classroom Status for School:	Permanent	Portable	Totals	Permanent	Portable	Totals	Permanent	Portable	Totals	
Available Classrooms 720 Square Feet or greater:	17	8	25	17	13	30	17	8	25	
Available Small Rooms 719 Square Feet or smaller:	0	0	0	0	0	0	0	0	0	
Totals:	17	8	25	17	13	30	17	8	25	

Analysis:

Several classroom spaces on campus have been converted to support the unique needs of the school. The uses include after school programs, specialist offices and a parent room. Should the need arise, the rooms may be converted back to classrooms.



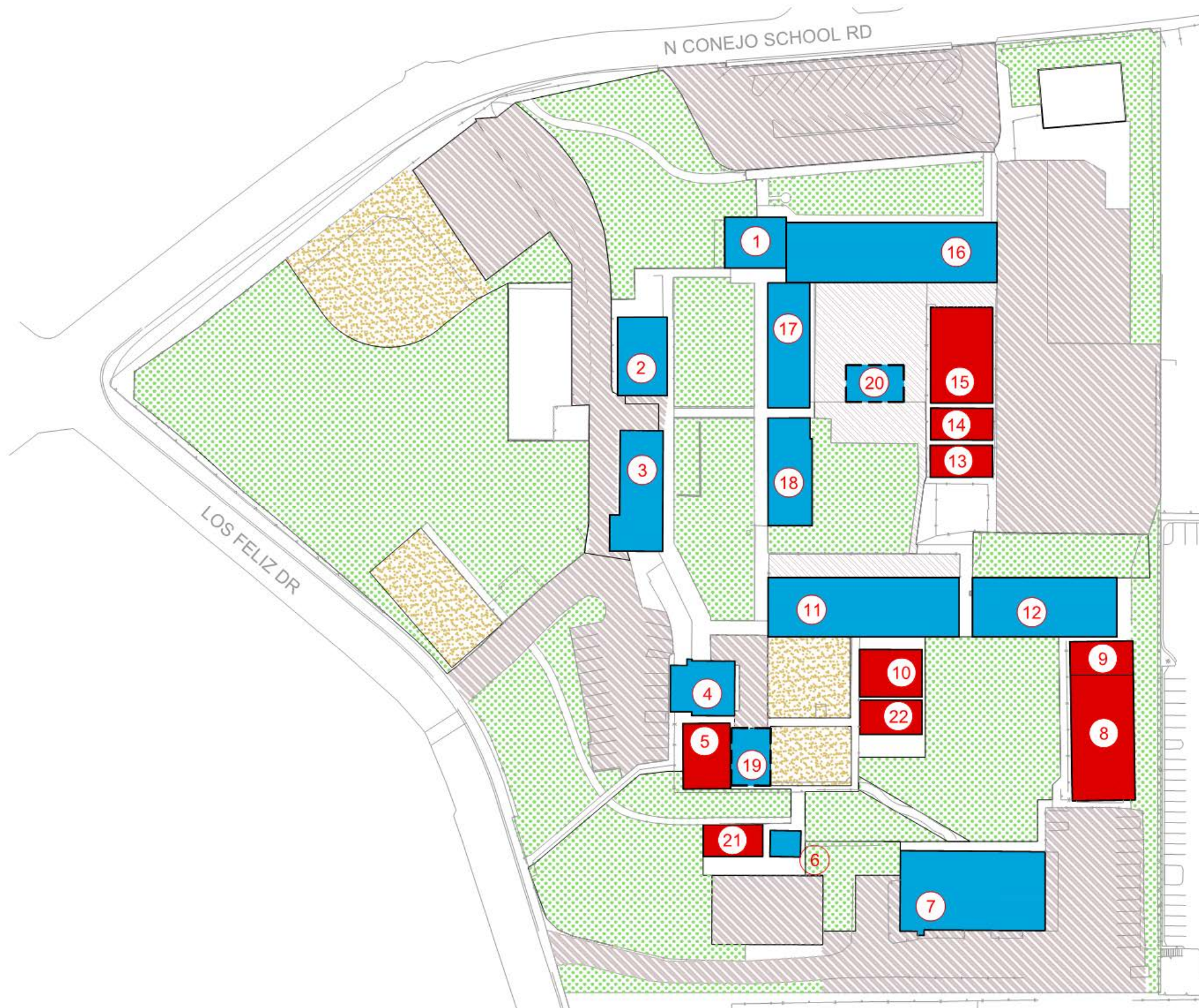

- BUILDING**
- 1- ADMINISTRATION
 - 2- LIBRARY
 - 3- CAFETERIUM
 - 4- KINDERGARTEN (PORTABLE)
 - 5- CHILD CARE (PORTABLE)
 - 6- RESTROOMS (CRPD)
 - 7- SPECIAL ED. PROGRAM
 - 8- CLASSROOM (PORTABLE)
 - 9- CLASSROOM (PORTABLE)
 - 10- KINDERGARTEN (PORTABLE)
 - 11- CLASSROOM
 - 12- CLASSROOM
 - 13- CLASSROOM (PORTABLE)
 - 14- CLASSROOM (PORTABLE)
 - 15- CLASSROOM (PORTABLE)
 - 16- CLASSROOM
 - 17- CLASSROOM
 - 18- CLASSROOM
 - 19- LUNCH SHELTER
 - 20- LUNCH SHELTER EXTENSION
 - 21- CLASSROOM (PORTABLE)
 - 22- CLASSROOM (PORTABLE)

**EXISTING SITE PLAN
PERMANENT & PORTABLE
BUILDINGS**

LEGEND	
(25)	BUILDING NUMBER
	PERMANENT
	PORTABLE

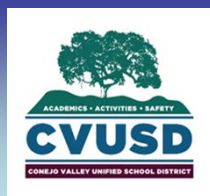
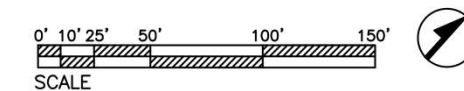

School District Site Name	Street Address	City	Zip Code St Plus Four	School District Building Name	Building Rating Classification	Square Footage	Fire Const. Code	Fire Const. Type	Roof Type	Year Built	Year Renovated				Status	Is Vacant Y/N
											Roof	HVAC	Electric	Plumbing		
Conejo Elementary	280 Conejo School Road	Thousand Oaks	CA 91362-3199	1-Administration	Elementary	816	1	Frame	Composition	1954	2008	1999	1999	2000	Owned and occupied by the district	N
Conejo Elementary	280 Conejo School Road	Thousand Oaks	CA 91362-3199	2-Library	Elementary	1,762	1	Frame	Composition	1966	1998	1999	1999	2000	Owned and occupied by the district	N
Conejo Elementary	280 Conejo School Road	Thousand Oaks	CA 91362-3199	3-Multipurpose/Kitchen	Elementary	3,479	1	Frame	Composition	1940	2008	1999	1999	2000	Owned and occupied by the district	N
Conejo Elementary	280 Conejo School Road	Thousand Oaks	CA 91362-3199	4-Kindergarten	Elementary	1,488	1	Frame	Composition	1948	2010	1999	1999	2000	Owned and occupied by the district	N
Conejo Elementary	280 Conejo School Road	Thousand Oaks	CA 91362-3199	5-Child Care	Elementary	1,440	5	Modified Fire Resistive	Metal	1990	1990	1990	1990	1990	Owned and occupied by the district	N
Conejo Elementary	280 Conejo School Road	Thousand Oaks	CA 91362-3199	6-Restroom Bldg	Elementary	357	2	Joisted Masonry	Composition	1960	1960			1960	Owned and occupied by the district	N
Conejo Elementary	280 Conejo School Road	Thousand Oaks	CA 91362-3199	7-Special Ed (Triggs)	Elementary	3,270	5	Modified Fire Resistive	Metal	1973	2008	1973	1973	1973	Owned and occupied by the district	N
Conejo Elementary	280 Conejo School Road	Thousand Oaks	CA 91362-3199	8-Classrooms (4)	Elementary	3,840	5	Modified Fire Resistive	Metal	1999	1999	1999	1999	1999	Owned and occupied by the district	N
Conejo Elementary	280 Conejo School Road	Thousand Oaks	CA 91362-3199	9-Classroom (1)	Elementary	960	5	Modified Fire Resistive	Metal	1999	1999	1999	1999	1999	Owned and occupied by the district	N
Conejo Elementary	280 Conejo School Road	Thousand Oaks	CA 91362-3199	10-Kindergarten	Elementary	1,440	5	Modified Fire Resistive	Metal	1999	1999	1999	1999	1999	Owned and occupied by the district	N
Conejo Elementary	280 Conejo School Road	Thousand Oaks	CA 91362-3199	11-Classrooms (4)	Elementary	4,466	1	Frame	Composition	1957	1999	1999	1999	2000	Owned and occupied by the district	N
Conejo Elementary	280 Conejo School Road	Thousand Oaks	CA 91362-3199	12-Classrooms (3)	Elementary	3,287	1	Frame	Composition	1954	1999	1999	1999	2000	Owned and occupied by the district	N
Conejo Elementary	280 Conejo School Road	Thousand Oaks	CA 91362-3199	13-Classroom (1)	Elementary	960	5	Modified Fire Resistive	Metal	1998	1998	1998	1998	1998	Owned and occupied by the district	N
Conejo Elementary	280 Conejo School Road	Thousand Oaks	CA 91362-3199	14-Classroom (1)	Elementary	960	5	Modified Fire Resistive	Metal	1997	1997	1997	1997	1997	Owned and occupied by the district	N
Conejo Elementary	280 Conejo School Road	Thousand Oaks	CA 91362-3199	15-Classrooms (3)	Elementary	2,880	5	Modified Fire Resistive	Metal	1997	1997	1997	1997	1997	Owned and occupied by the district	N
Conejo Elementary	280 Conejo School Road	Thousand Oaks	CA 91362-3199	16-Classrooms (5) 21-26	Elementary	4,800	1	Frame	Composition	1954		1999	1999	2000	Owned and occupied by the district	N
Conejo Elementary	280 Conejo School Road	Thousand Oaks	CA 91362-3199	17-Classrooms (2)	Elementary	2,702	1	Frame	Composition	1948	1999	1999	1999	2000	Owned and occupied by the district	N
Conejo Elementary	280 Conejo School Road	Thousand Oaks	CA 91362-3199	18-Classrooms (2)	Elementary	2,289	1	Frame	Composition	1948	1999	1999	1999	2000	Owned and occupied by the district	N
Conejo Elementary	280 Conejo School Road	Thousand Oaks	CA 91362-3199	21 - Classroom	Elementary	960	5	Modified Fire Resistive	Composition	2002	2003	2003	2003		Owned and occupied by the district	N
Conejo Elementary	280 Conejo School Road	Thousand Oaks	CA 91362-3199	22 - Classroom	Portable	960	5	Modified Fire Resistive	Metal	2003	2003	2003	2003	2003	Owned and occupied by the district	N



Existing Facilities:

11 buildings are over 40 years old

Analysis:

The permanent buildings on the campus were between 43 and 76 years old at the time this survey was taken. The portable buildings were between 13 and 26 years old. As some buildings, notably Building 12, are situated at the bottom of a slope, water intrusion has degraded some building components. The portable buildings are aging and require maintenance. Most roofing at permanent buildings is between 6 and 18 years old; roofing at Restroom Building 6 is original. Most major building systems of permanent buildings are between 17 and 18 years old. Building systems at Special Education Building 7 is original.

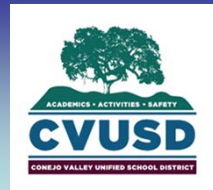

KEY NOTES

- 1 THIS GENERAL CLASSROOM IS BEING USED FOR MUSIC AND ADULT CLASS TUTORING.
- 2 THIS GENERAL CLASSROOM IS BEING USED FOR THE STAR PROGRAM IN THE AFTERNOON.
- 3 THIS GENERAL CLASSROOM IS BEING USED AS A INTERVENTION SPECIALIST OFFICE.
- 4 THIS GENERAL CLASSROOM IS BEING USED AS A PARENT ROOM.
- 5 THIS GENERAL CLASSROOM IS BEING USED AS AN ART CLASSROOM AND A BASIC CLASSROOM.
- 6 THIS GENERAL CLASSROOM IS BEING USED AS A SPEECH PATHOLOGIST OFFICE.
- 7 THIS GENERAL CLASSROOM IS BEING USED AS A SCIENCE CLASSROOM.
- 8 THIS IS THE COUNTY SPECIAL EDUCATION BUILDING. SPACES APPEAR TO HAVE BEEN RENOVATED. SPACES SHOWN HERE ARE APPROXIMATE LOCATIONS OF RELOCATED PARTITIONS. THESE SPACES ARE NOT INCLUDED IN THE CLASSROOM OR AREA COUNT IN THIS DOCUMENT.
- 9 THIS PORTABLE CLASSROOM IS NOT IN USE
- 10 THIS SPACE WAS A TITLE ROOM. IT IS NOW BEING USED AS THE OUTREACH COORDINATORS OFFICE.
- 11 THIS SPACE WAS A SPEECH THERAPY ROOM. IT IS NOW BEING USED AS A SHARED OFFICE SPACE FOR THE PSYCHOLOGIST AND COUNSELOR.
- 12 THIS SPACE WAS A SPEECH ROOM. IT IS NOW BEING USED AS A PLANT MANAGER'S OFFICE.
- 13 THIS GENERAL CLASSROOM IS BEING USED AS A COMPUTER LAB.
- 14 THIS GENERAL CLASSROOM IS BEING USED AS A SPED CLASSROOM
- 15 THIS GENERAL CLASSROOM IS BEING USED AS A COMPUTER LAB.



INTERIOR BUILDING SPACES CURRENT USES

LEGEND

INSTRUCTIONAL

- BASIC CLASSROOM
- SPECIALITY CLASSROOM
- SCIENCE CLASSROOM
- SMALL ROOM
- CLASSROOM SUPPORT

GENERAL

- ATHLETIC
- LIBRARY/MEDIA
- STUDENT SUPPORT
- ADMINISTRATIVE
- ASSEMBLY
- CIRCULATION
- OPERATIONAL SUPPORT
- FOOD SERVICE
- SPACE IS NOT USED

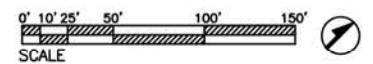

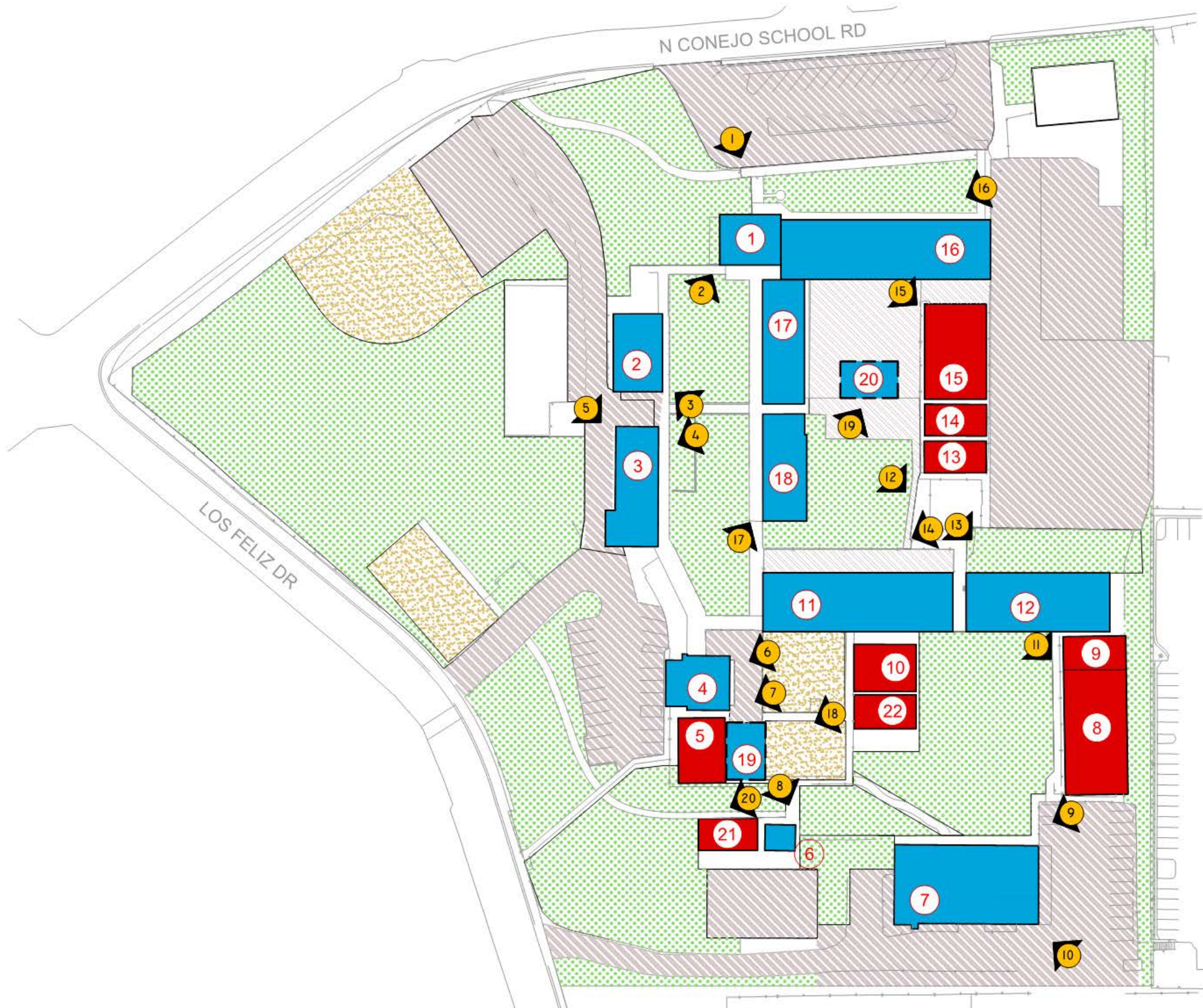

- BUILDING**
- 1- ADMINISTRATION
 - 2- LIBRARY
 - 3- CAFETERIUM
 - 4- KINDERGARTEN (PORTABLE)
 - 5- CHILD CARE (PORTABLE)
 - 6- RESTROOMS (CRPD)
 - 7- SPECIAL ED. PROGRAM
 - 8- CLASSROOM (PORTABLE)
 - 9- CLASSROOM (PORTABLE)
 - 10- KINDERGARTEN (PORTABLE)
 - 11- CLASSROOM
 - 12- CLASSROOM
 - 13- CLASSROOM (PORTABLE)
 - 14- CLASSROOM (PORTABLE)
 - 15- CLASSROOM (PORTABLE)
 - 16- CLASSROOM
 - 17- CLASSROOM
 - 18- CLASSROOM
 - 19- LUNCH SHELTER
 - 20- LUNCH SHELTER EXTENSION
 - 21- CLASSROOM (PORTABLE)
 - 22- CLASSROOM (PORTABLE)

EXISTING SITE IMAGE KEY MAP



PERMANENT & PORTABLE BUILDINGS

LEGEND	
(25)	BUILDING NUMBER
	PERMANENT
	PORTABLE

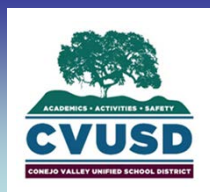
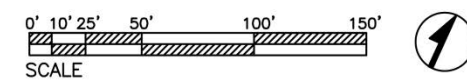



Photo 1
 Building Name: Administration
 Building Number: 1
 Description: School entrance with administration to the right.



Photo 2
 Building Name: Administration
 Building Number: 1
 Description: Principals office and view of administration from inside the campus



Photo 3
 Building Name: Library, Parent Outreach and Teacher Lounge
 Building Number: 2
 Description: Exterior view of entrance to Library and Parent Outreach



Photo 4
 Building Name: Multi Purpose Room and Servery
 Building Number: 3
 Description: Exterior view of entrance to Servery and Multi Purpose Room



Photo 5
 Building Name: Multi Purpose Room and Servery
 Building Number: 3
 Description: View of MPR from play courts.



Photo 6
 Building Name: Classroom
 Building Number: 4
 Description: Kindergarten building with separate play area. Comments were made as to how low the fence is around the perimeter of the area.



Photo 7
 Building Name: Portable Classroom
 Building Number: 5
 Description: 40x40 Child Care Center



Photo 8
 Building Name: Restroom
 Building Number: 6
 Description: Building does not meet accessibility requirements. Additionally, there is no accessible path of travel from the upper campus to this location.



Photo 9
 Building Name: Special Education
 Building Number: 7
 View of the County run Special Education Building.

Photo 10
 Building Name: Special Education
 Building Number: 7
 This facility is operated separately from Conejo Elementary School.

Photo 11
 Building Name: Portable Classroom
 Building Number: 8/9
 Portables with permanent accessibility ramp.

Photo 12
 Building Name: N/A
 Building Number: N/A
 The Learning Garden, adjacent to Portable Building 13. Used as both a garden and as a gathering space for community activities, this area is an important fixture on campus.



Photo 13
 Building Name: Classroom
 Building Number: 11
 Classroom buildings 11-12 have large overhangs for shade, and clerestory windows to improve natural lighting.

Photo 14
 Building Name: Classroom
 Building Number: 12
 Classroom building at the bottom of a steep grass hill, which poses drainage concerns during heavy rains.

Photo 15
 Building Name: Classroom
 Building Number: 13-15
 View of ramps leading up to the music classroom.

Photo 16
 Building Name: Classroom
 Building Number: 16
 Classroom fronts onto generous lawn space.



Photo 17

Building Name: Classroom
 Building Number: 17-18
 Classroom buildings 17-18 have large overhangs for shade, and clerestory windows to improve natural lighting.



Photo 18

Building Name: Lunch Shelter
 Building Number: 19
 Lunch shelter near kindergarten classrooms.



Photo 19

Building Name: Lunch Shelter
 Building Number: 20
 Lunch shelter near Administration.



Photo 20

Building Name: Portable Classroom
 Building Number: 21
 This building is no longer being used and the exterior is in poor condition.



Photo 21

Building Name: Portable Classroom
 Building Number: 13
 Parent room.



Photo 22

Building Name: Classroom
 Building Number: 16
 Typical classroom interior for buildings 11,12,16.



Photo 23

Building Name: Classroom
 Building Number: 18
 Typical classroom interior for buildings 17-18.



Photo 24

Building Name: Classroom
 Building Number: 16
 View of computer classroom.

After School Enrichment (Band, Chorus, Wednesday Clubs)

AFTER SCHOOL ENRICHMENT (Fee-based) CLASSES:

BAND

Our Conejo Band is lead by our Band Teacher, Ms. Langlois for 4th and 5th grade students. Band is offered 2 semesters each year, in Fall and Spring. Band is a fee based class and scholarships are available.

CHORUS

Our Conejo Chorus is lead by our Music Teacher, Ms. Aileen Scott for K-5th grade students. Chorus is offered 2 semesters each year, in Fall and Spring. Chorus is a fee based class and scholarships are available.

WEDNESDAY CLUBS

Our Wednesday Clubs are offered on Wednesdays from 1:30-2:40pm for students in 1st - 5th grade. There are 2 semesters offered each year, Fall and Spring. These Clubs are optional and free of charge. Clubs are selected by lottery. You can choose to pick up your child at 1:30pm and therefore, you do not select a club for your child. The Fall semesters runs from Sept - Jan . The Spring semesters runs from Jan - June.

STAR AFTERSCHOOL PROGRAM

The STAR Afterschool Program is a FREE afterschool program for students in Kindergarten thru 5th grade. Students must attend each day afterschool from dismissal until 6pm. Space is limited. At this time the program is full and new applicants will be placed on the wait list.



Login

December 01, 2016

Home Open to Possibilities The 7 Habits Our Educators Hands-On Learning How To Apply In The News

Open to Possibilities

The Open Classroom Leadership Magnet is a unique opportunity for families to be a part of an educational community of teachers, parents and staff that work closely together to create a learning environment focused not only on academics, but on the whole child--social, emotional and ethical. At OCLM, we recognize and build on the talents and abilities of each student so that we can help them emerge as leaders now, and continue to inspire others as they grow.

The classrooms are student-centered so that the kids participate in the learning process and take responsibility for their progress along with their teacher. Open Classroom families are part of a dedicated community focused on fulfilling academic expectations and supporting students' growth and development as individuals. This is accomplished through unique, hands-on experiences in and out of the classroom that include whole-school activities and events, mentoring one-on-one and in mixed-age groups, and creative, interdisciplinary projects.

The Foundation of the Program for 20 years:

Focus on personal leadership develops strong communication, conflict resolution and problem solving skills; promotes the ability to make good choices.

Multi-age classrooms encourage collaboration, foster mentoring between children, enable teachers to differentiate based on individual student needs.

Small learning environments support hands-on, creative projects and lessons, and facilitate program-wide events such as Fun Fridays, Fall Festival, and our Stepping Up ceremony.



Parent and family involvement creates a learning environment that supports classroom instruction and builds relationships among parents, students and teachers.

With this philosophy, and a set of timeless principles borrowed from the 7 Habits of *The Leader in Me*, Open Classroom Leadership Magnet encourages students to pursue their personal best. They learn to:

- Take responsibility for the choices they make and actions they take
- Develop goals based on their values and have a plan to get there
- Listen well, collaborate and respect others
- Balance social, physical, spiritual and intellectual activities

What Makes it Work--Parent Involvement

Parents support both the teachers and students when they volunteer in the classroom, and become an integral part of the creative, stimulating, respectful and productive learning environment we enjoy at OCLM. Parents also enrich the curriculum by sharing their own knowledge, skills and experiences with the students as a guest in the classroom. And, input from our families is part of the collaboration we value at OCLM. Most importantly, their presence in the classroom demonstrates a value of education, and a commitment to being engaged in their child's learning.



Conejo Elementary School | Survey

280 North Conejo School Road | Thousand Oaks, CA 91362

Conejo Valley Unified School District

March 31, 2017

Specialized Programs

8.0

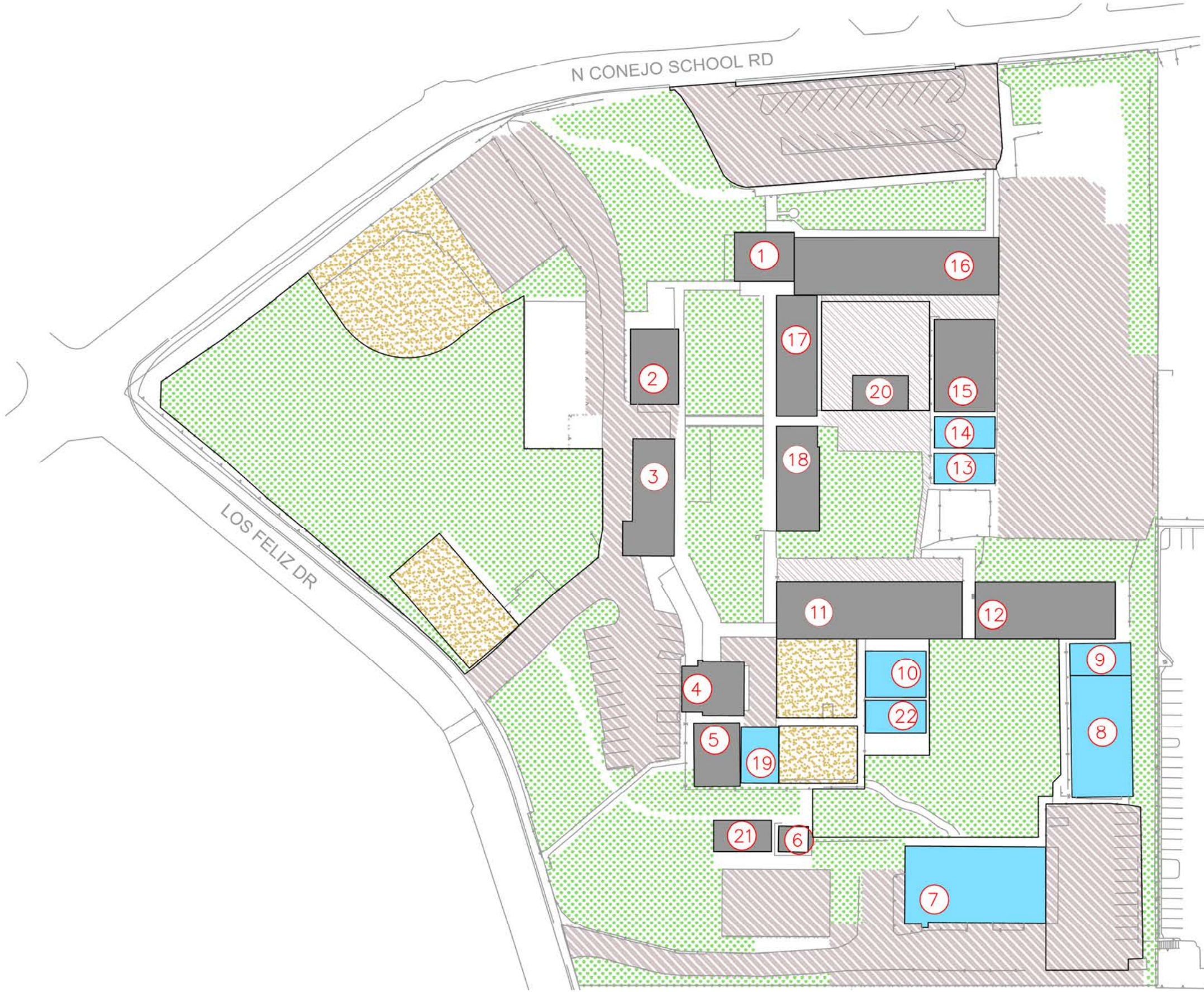

- BUILDING**
- 1- ADMINISTRATION
 - 2- LIBRARY
 - 3- CAFETORIUM
 - 4- KINDERGARTEN (PORTABLE)
 - 5- CHILD CARE (PORTABLE)
 - 6- RESTROOMS (CRPD)
 - 7- SPECIAL ED. PROGRAM
 - 8- CLASSROOM (PORTABLE)
 - 9- CLASSROOM (PORTABLE)
 - 10- KINDERGARTEN (PORTABLE)
 - 11- CLASSROOM
 - 12- CLASSROOM
 - 13- CLASSROOM (PORTABLE)
 - 14- CLASSROOM (PORTABLE)
 - 15- CLASSROOM (PORTABLE)
 - 16- CLASSROOM
 - 17- CLASSROOM
 - 18- CLASSROOM
 - 19- LUNCH SHELTER
 - 20- LUNCH SHELTER EXTENSION
 - 21- CLASSROOM (PORTABLE)
 - 22- CLASSROOM (PORTABLE)

CERTIFICATIONS REQUIRED

LEGEND	
(25)	BUILDING NUMBER
	CERTIFICATION REQUIRED
	CERTIFIED STRUCTURES

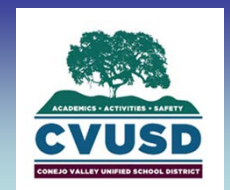
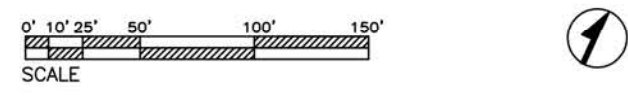



Site Challenges:

There are four primary site challenges at Conejo Elementary School. First, there are many grade changes within the site. The apparent paths of travel do not flow along the shortest routes from point A to point B. Students from the County-run Special Education program must go along an extended route to access the play fields. The juncture between the playfields and the building core is composed of stairs and steeply sloping asphalt. This is both a safety and accessibility challenge. The grade changes also create concerns with drainage and water intrusion into buildings.

Second, the campus is aging. Plumbing, mechanical and electrical infrastructure are dated, and play equipment is showing signs of wear. Third, accessible, distributed and age-appropriate restrooms are lacking. Kindergarten restrooms are not available for all kindergarten classrooms. The southern portion of campus is served by Restroom Building 6, which is aging, inaccessible and inconveniently located. Last, the sense of security on the campus is lacking. All adjacent playfields are shared between the school and the community; while this is an important and beneficial relationship, it also results in some instances of vandalism.

Site Modernization Opportunities:

Campus improvement opportunities are as follows:

Campus modernization projects are intended to improve the safety and security of the students, better the instructional and play environments, and beautify the campus internally as well as its face to the neighborhood. Currently, the main face of the campus is the school's parking lot and student drop-off, framed by mature trees and a green lawn. There is great opportunity here to improve the school's aesthetic front to the community with school signage, site lighting, enhanced fencing, and removal of fencing where not required. Reimagining the school's secondary face along Los Feliz Drive would be a benefit as well, and would aid in securing the site perimeter.

The topographic changes within the site are a unique element in the campus that provides the students with varied environments for play, and experience with shifting scales of landscape. There is an opportunity to modernize the campus' level of accessibility to make this available to all students. A holistic overview of bringing Conejo Elementary School up to current standards of accessibility may involve improvements to restrooms, restroom additions, hardware, signage, classroom plumbing fixtures, drinking fountains and path of travel.

To address the general age of the campus, modernization could encompass replacement of aging plumbing and sewer lines, the installation of more efficient HVAC equipment and a reevaluation of electrical needs. Paint and more energy efficient glazing systems would significantly improve the instructional environments. Digital signage and replacement of aging play structures have been noted as desirable enhancements.





Image 1: DROP OFF ENTRANCE



Image 2: DROP OFF EXIT

BUILDING

- 1- ADMINISTRATION
- 2- LIBRARY
- 3- CAFETORIUM
- 4- KINDERGARTEN (PORTABLE)
- 5- CHILD CARE (PORTABLE)
- 6- RESTROOMS (CRPD)
- 7- SPECIAL ED. PROGRAM
- 8- CLASSROOM (PORTABLE)
- 9- CLASSROOM (PORTABLE)
- 10- KINDERGARTEN (PORTABLE)
- 11- CLASSROOM
- 12- CLASSROOM
- 13- CLASSROOM (PORTABLE)
- 14- CLASSROOM (PORTABLE)
- 15- CLASSROOM (PORTABLE)
- 16- CLASSROOM
- 17- CLASSROOM
- 18- CLASSROOM
- 19- LUNCH SHELTER
- 20- LUNCH SHELTER EXTENSION
- 21- CLASSROOM (PORTABLE)
- 22- CLASSROOM (PORTABLE)

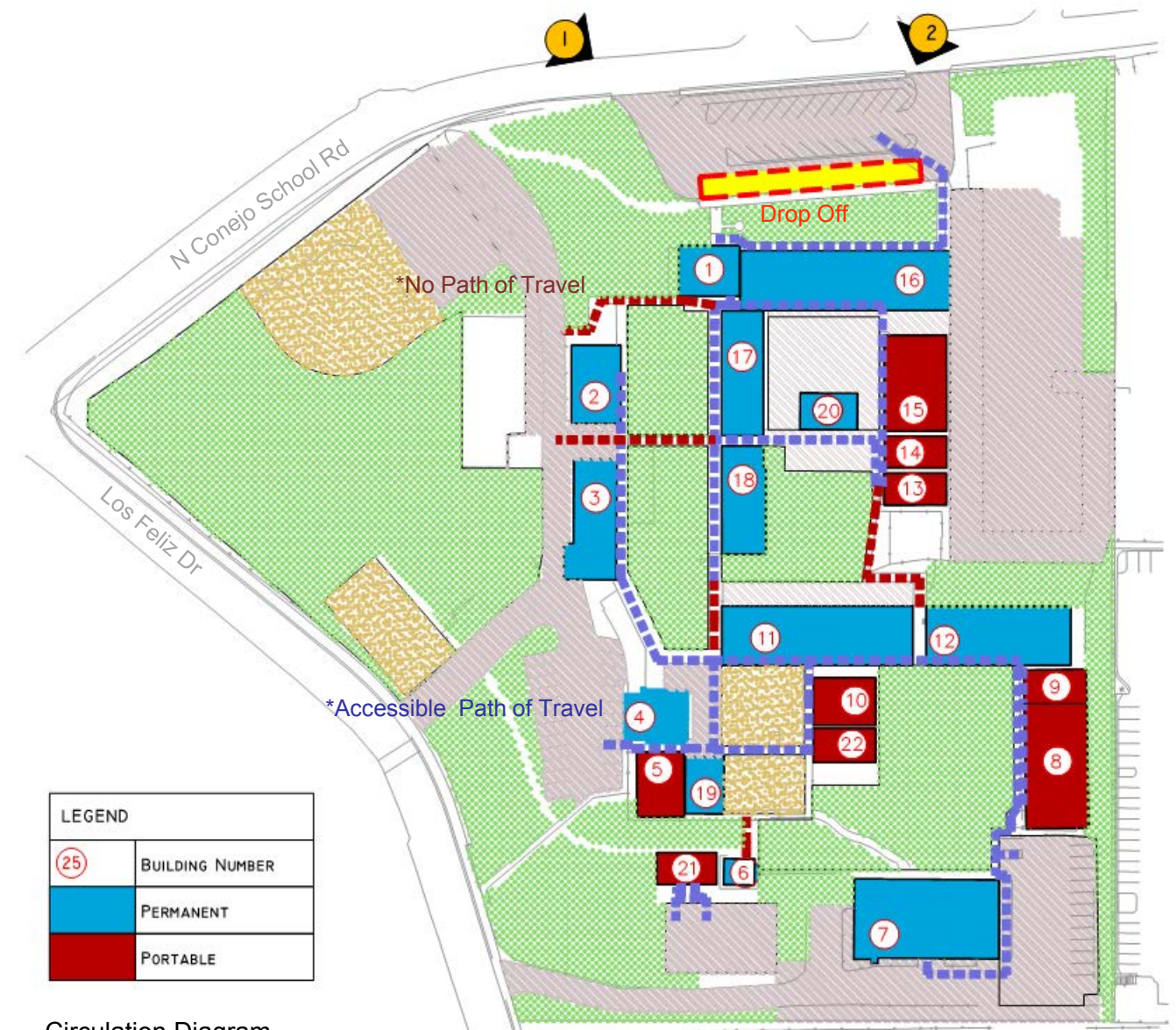

Circulation Diagram

*Visually observed to be the accessible path of travel. Verification required.

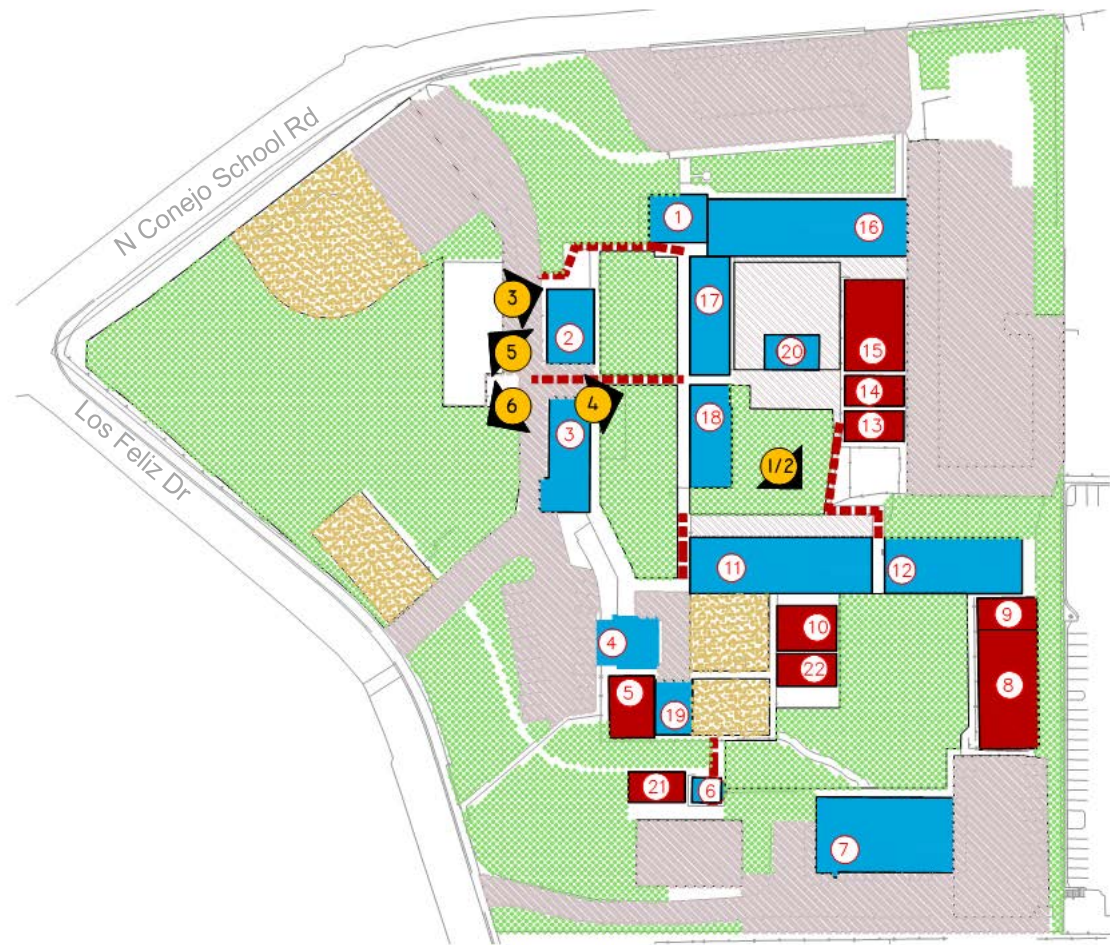

EXISTING SITE
IMAGE KEY MAP



PERMANENT & PORTABLE
BUILDINGS

LEGEND	
(25)	BUILDING NUMBER
[Blue Box]	PERMANENT
[Red Box]	PORTABLE



Photo -1
Landing at top of ramp does not appear to comply with current accessibility standards



Photo -2
Ramp does not appear to comply with current accessibility standards.



Photo -3
Stairs and adjacent slopes do not appear to comply with current accessibility standards.



Photo -4
Ramp does not appear to comply with current accessibility standards.



Photo -5
Steeply sloping asphalt adjacent to play areas is an accessibility and safety concern.



Photo -6
Steeply sloping asphalt adjacent to play areas is an accessibility and safety concern.

Energy Use Summary

[CONEJOELEM_1] Conejo Elem

Electric	2,425 KWH	\$4,164	\$1,319	\$2,845	68.3%
Natural Gas	0 THERM	\$30	\$14	\$15	52.0%
Water	462 CCF	\$4,514	\$2,449	\$2,065	45.7%
Totals:	8 MMBTU	\$8,707	\$3,782	\$4,926	56.6%

Place: [CONEJOELEM_1] Conejo Elem

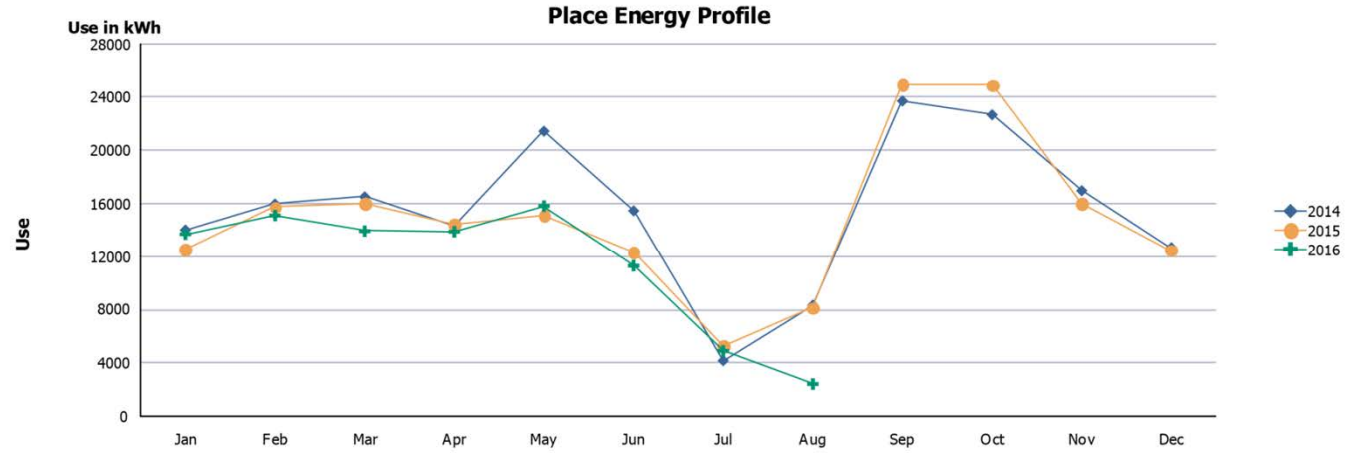

Year	Jan	Feb	Mar	Apr	May	Jun	Jul	Aug	Sep	Oct	Nov	Dec	Totals
2014	14,021	15,973	16,517	14,366	21,445	15,460	4,174	8,337	23,720	22,685	16,977	12,692	186,367
2015	12,520	15,741	15,992	14,426	15,125	12,329	5,237	8,117	24,937	24,898	16,004	12,465	177,791
2016	13,700	15,110	13,933	13,890	15,820	11,293	4,900	2,425	0	0	0	0	91,071
Totals	40,241	46,824	46,442	42,682	52,390	39,082	14,311	18,879	48,657	47,583	32,981	25,157	455,229

Electrical

Place: [CONEJOELEM_1] Conejo Elem

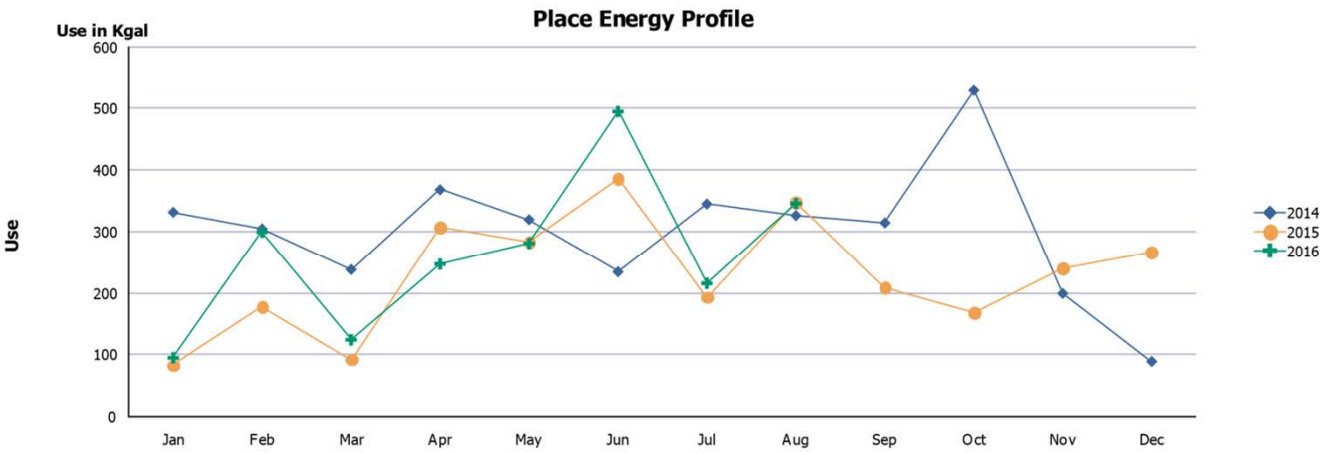

Year	Jan	Feb	Mar	Apr	May	Jun	Jul	Aug	Sep	Oct	Nov	Dec	Totals
2014	331	304	238	368	319	234	345	326	314	530	199	89	3,598
2015	83	177	92	307	283	386	193	348	208	168	239	266	2,750
2016	95	299	124	247	281	495	215	346	0	0	0	0	2,102
Totals	509	781	454	922	883	1,115	753	1,020	522	697	438	355	8,451

Water

Place: [CONEJOELEM_1] Conejo Elem

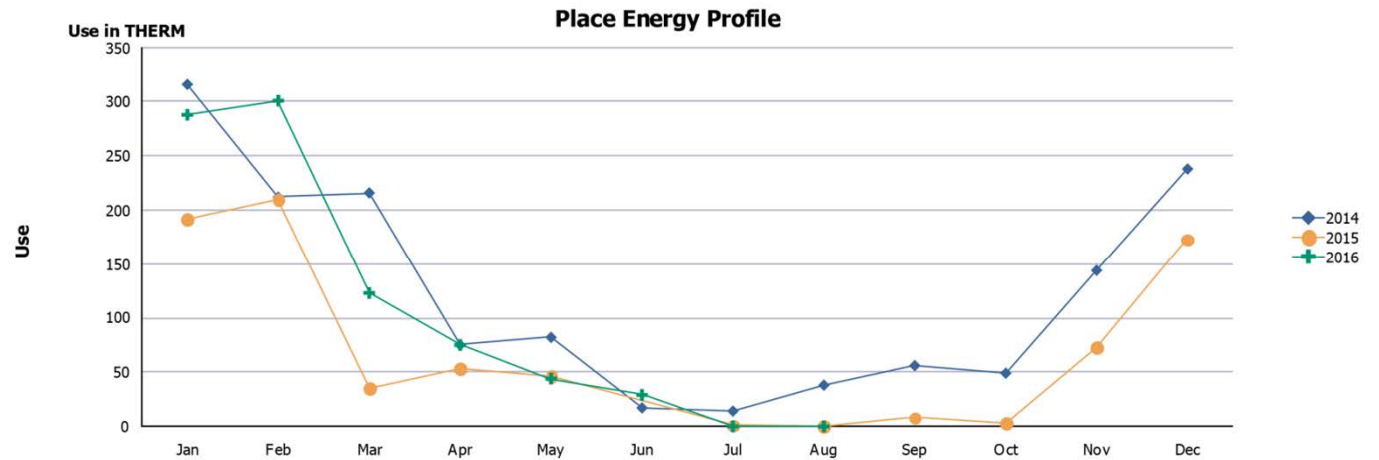

Year	Jan	Feb	Mar	Apr	May	Jun	Jul	Aug	Sep	Oct	Nov	Dec	Totals
2014	316	212	216	75	82	17	14	38	56	49	144	238	1,457
2015	192	210	35	53	46	0	1	0	8	3	73	173	794
2016	288	301	123	75	44	29	0	0	0	0	0	0	860
Totals	796	723	374	203	172	46	15	38	64	52	217	411	3,111

Gas



Core Facilities			
Item	Category	Existing Square Footage	Standard Square Footage Based on Planning 2- Semester Capacity
1	Food Prep & Serving Areas	446 Square Feet	1,700 Square Feet
2	Indoor Dining	0 Square Feet	2,640 Square Feet
3	Lunch Shelter	2,610 Square Feet	1,800 Square Feet
4	Multi Purpose/Assembly/Auditorium	1,777 Square Feet	4,140 Square Feet
5	Library	1,080 Square Feet	1,970 Square Feet
6	Administration	2,535 Square Feet **(Office Square Footage)	2,080 Square Feet * (Office Square Footage)
7	Gymnasium Building	NA	N/A
8	Playground	2.95 Acres	1.61 Acres
9	Parking	91 Standard/ADA	68 Stalls

*(Office Square Footage)

This calculation includes the Front Office/Main Office; Waiting Room/Space; Conference Room; Administrative Offices. ** This calculation includes the Staff Lounge in addition to the spaces listed above.

Core Facilities Summary

1. Food Prep & Serving Areas
The Food Prep & Serving Areas are undersized per District standards, but meets the school's needs. Lunch time activities are staggered.

2. Indoor Dining
There is no indoor dining on campus.

3. Lunch Shelter
There are two lunch shelters on campus: one for kindergarteners and another for the rest of the campus. These two structures meet the needs of the school.

4. Multi Purpose/Assembly/Auditorium
The Multi-Purpose room is undersized per District standards but meets the needs of the school. This building is the oldest on campus and lacks sufficient storage

5. Library
The library is undersized per District standards and lacks sufficient storage.

6. Administration
The main administrative office is undersized and does not meet the needs of the school. Circulation through that area is especially difficult. Spaces originally designed as classrooms are now used as office space and student support. The existing staff lounge is undersized.

7. Gymnasium Building
N/A

8. Playground
The playground is shared with the community and the acreage meets the school's needs. However, there is no accessible path of travel to this zone, and the County Special Ed must walk a long distance to use this space. Play structures are aging

9. Parking
Parking count is not sufficient for the needs of the school.

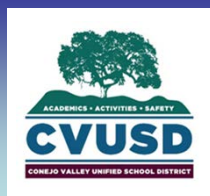

Technology Summary:

The network infrastructure has been upgraded to meet current and future needs. Each building that has an IDF is connected to the MDF via 12 strands of single mode fiber. Every classroom has two locations with two CAT6 A cables along the wall and four cables in the ceiling. A 12 port switch is installed in each classroom to accommodate additional computers. All other instructional and office spaces have newly installed CAT6 A cables. Wireless access points have been installed in all indoor instructional and office spaces in a micro-cell arrangement to ensure the ability to support a 1 to 1 student to device rollout. Outdoor wireless coverage is currently being evaluated. Switch gear that support a 10Gbps backbone and 1Gbps Power Over Ethernet connections is installed in every IDF and MDF. The current speed of the backbone is limited to 1Gbps but can be increased with new fiber optic transceivers.

Room Name	Computer	Quantity	Projector Model	Smartboard Model	Printer Model	Document Reader	Other	Wireless AP	Network Switch	Remarks
Classroom	Dell Optiplex 755		Boxlight	Active Board	HP 4200	CP150				
Classroom	2 Dell Optiplex 380									
Classroom	Lenovo M series		Boxlight	Active Board	Dell 2300	CP150				
Classroom	3 Optiplex 380, 2 Optiplex 760									
Classroom	Lenovo M series		Boxlight	Active Board	HP 4000	CP150				
Classroom	5 dell opt380									
Classroom	Lenovo M series		Boxlight	Active Board	HP 4000	CP150				
Classroom	5 dell opt380									
Classroom	Lenovo M series		Boxlight	Active Board	HP M252DW	CP150				
Classroom	6 Ipads									
Classroom	Dell Optiplex 755									
Classroom	40 Opt755									
Classroom	Lenovo M series		Boxlight		HP 2150	CP150				
Classroom	6 lenovo Laptops									
Classroom	Dell 3020		Boxlight		HP 4000	CP150				
Classroom	6 lenovo Laptops									
Classroom	Dell 3020		Boxlight		Dell 2330					
Classroom	1 Opt 790									
Classroom	Dell 3020		Boxlight		HP Deskjet 6127	CP150				
Classroom	6 lenovo Laptops									
Classroom	Lenovo M series		Boxlight		Dell 1765	CP150				
Classroom	6 lenovo Laptops									
Classroom	Dell 380		Epson 83+		Brother 8080	CP150				
Classroom	Dell 320		Boxlight		HP 4000					
Classroom	2 Opt760, 3 OPT 790									
Classroom	Dell Optiplex 780		Epson 83+		Dell C2660dn					
Classroom	30 Ipads,40 OPT980									
Classroom	Lenovo M series		Boxlight		HP 4000	CP150				
Classroom	14 HP Tablets , 5 OPT 380									
Classroom	Lenovo M series		Boxlight		HP M252DW	CP150				
Classroom	5 OPT 380									
Classroom	Dell 760		Boxlight	Active Board	HP 4000	CP150				
Classroom	5 OPT 380									
Classroom	Lenovo M series		Boxlight	Active Board	HP C2660	CP150				
Classroom	6 lenovo Laptops									
Classroom	Dell 760		Boxlight	Active Board	HP7760	CP150				
Classroom	5 OPT 380									
Classroom	Lenovo M series		Boxlight	Active Board	Dell 2330	CP150				
Classroom	5 OPT 380									
Classroom	Lenovo M series		Boxlight	Active Board		CP150				



Technology Summary Continued:

Room Name	Computer	Quantity	Projector Model	Smartboard Model	Printer Model	Document Reader	Other	Wireless AP	Network Switch	Remarks
Classroom	14 HP Tablets , 5 OPT 380									
Classroom	Dell Optiplex 755									
Classroom	Dell 320		Epson 83+		Brother 7460	CP150				
Classroom	3 OPT380									
Classroom	Dell 760		Boxlight		HP4050					
Classroom	4 OPT 380									
Classroom	Dell 760		Boxlight		HP M252DW	CP150				
Classroom	3 OPT380									
Classroom	Lenovo M series		Boxlight	Active Board	HP M252DW	CP150				
	4 OPT 380									
	DEll Latitude 6401 LAptop				HP 4050					
	Dell 760		Epson 83+		HP2210xi	CP150				
	Dell 760 , 2 OPT745		Epson 83+							
Office	Dell Optiplex 780									
Nurse	Dell Optiplex 780									
Principal	Surface Pro 4									
Office	Dell Optiplex 780									
Kitchen	Dell OPT 760									



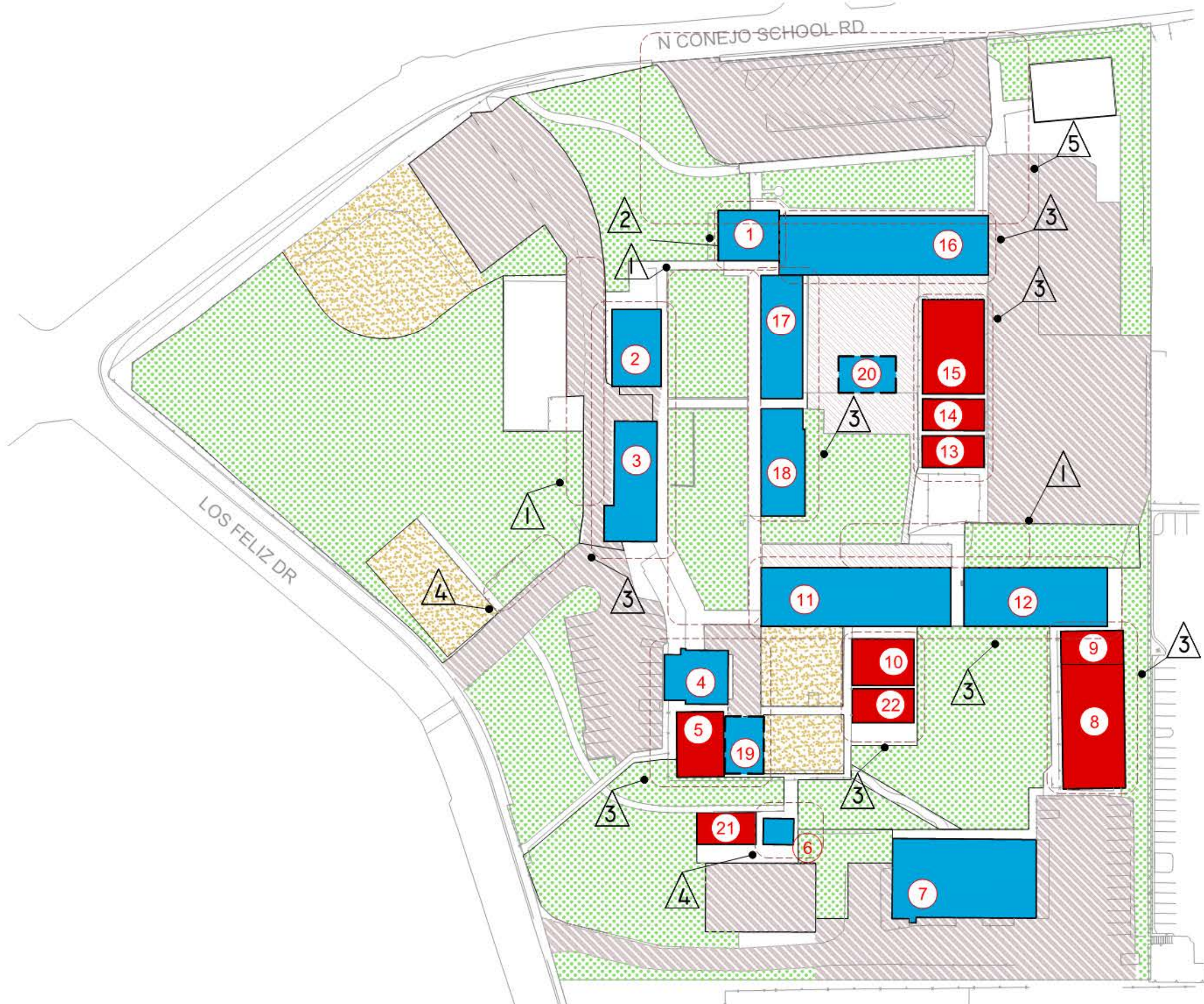

KEY NOTES

- 1** ACCESSIBILITY: ACCESSIBLE PATH OF TRAVEL TO THE FIELDS NEEDS TO BE IMPROVED. THIS CAN BE ADDRESSED WITH THE ADDITION OF SECURITY FENCING AND LANDSCAPING TO ENHANCE THE SCHOOLS APPEARANCE.
- 2** ADMINISTRATION: THE MAIN ADMINISTRATION OFFICE IS UNDERSIZED AND WOULD BENEFIT FROM EXPANSION.
- 3** BUILDING IMPROVEMENTS: REPLACEMENT OF INTERIOR AND EXTERIOR FINISHES, ROOFING, AND HVAC UNITS WOULD IMPROVE USABILITY AND THE APPEARANCE OF THE SCHOOL.
- 4** BUILDING IMPROVEMENTS: IMPROVEMENTS AIMED AT ACCESSIBLE RESTROOMS FOR ALL PARTS OF THE CAMPUS WOULD GREATLY HELP THE CAMPUS IN ADDITION TO ACCESS FOR THE PUBLIC DURING USE OF PLAYFIELDS.
- 5** FACE OF THE SCHOOL: IMPROVEMENTS AIMED AT MODERNIZING EXTERIOR FINISHES SITE WORK AND PARKING WOULD ENHANCE THE SCHOOL'S FACE TO THE NEIGHBORHOOD.

EXISTING SITE PLAN PERMANENT & PORTABLE BUILDINGS

LEGEND	
25	BUILDING NUMBER
 	PERMANENT
 	PORTABLE

